LP-810/W Low-intensity Type A Double Solar Aviation Obstruction Light



Application

LP-810/W Low-intensity Type A Double Solar-Powered Aviation Obstruction Light can be provided with power supply without power transmission cables by solar power, so it is suitable for those locations, Electric Tower, High-rise Building, High Chimney, marking towers (Telecom, GSM, Microwave & TV), High Pole, Tower Crane, Wind Turbine and other potentially hazardous obstructions within 45 meters to air traffic with a steady burning red safety light, especially which are hard to lay the cable or lack of power supply as well as those facilities which have high requirements on lightning protection.

Advantage

- International advanced solar panel reaching at least 10 years service life.
- Comprehensive protection in voltage short, over-voltage, floating Charge and temperature.
- Built-in Solar Panel.
- Strong corrosion resistance, Rain and Snow, Shock and Vibrations protection and UV protection.
- International-advanced cold LED with low power consumption, high brightness and service life of light source reaching 100000hours.
- Clean, renewable, green and reliable energy source
- Dusk-to-dawn operation:Light can work at night automatically by solar panel which function is equal to photocell sensor.
- At least 7 days autonomy.
- Recyclable 3 to 5years Lithium iron phosphate battery(LiFePO₄) with the lightest environmental.
- Small volume especially being suitable for Telecom Tower and Electric installation way.
- Main(Service)-standby way.As usual,Main(Service) light works,standby light does not operate;Once Main(Service) light fails,standby light will work automatically.

Main Parameter

Name	Data
Model	LP-810/W
Standard	ICAO (Aerodromes Annex 14) Low-intensity Type A and FAA L-810
Light intensity	≥10cd
Flash rate	Steady-burning mode or Flashing mode (20-60times/minute)
Light source	LED,≥100,000hours
Operating voltage	DC12V(Solar powered Way)
Battery	-Lithium iron phosphate battery(LiFePO ₄) -Capacity:12V,12Ah -Battery Replace:Yes
Power Source(Solar Module)	-Mono-crystalline silicon --Solar Efficiency:19%
Power consumption	≤4W
Overall size(mm)	137 by 120 by 208
Installation size(mm)	246 by 246 by 12
Vertical degree	≥10°
Horizontal degree	360°
Material	-Housing: PC -Base: die casting aluminum
Weight	5.3Kg
Emitting color	Red
Ambient temperature	-40℃~+60℃
Wind load	80m/s
Protection standard	IP65

Dimension Drawing

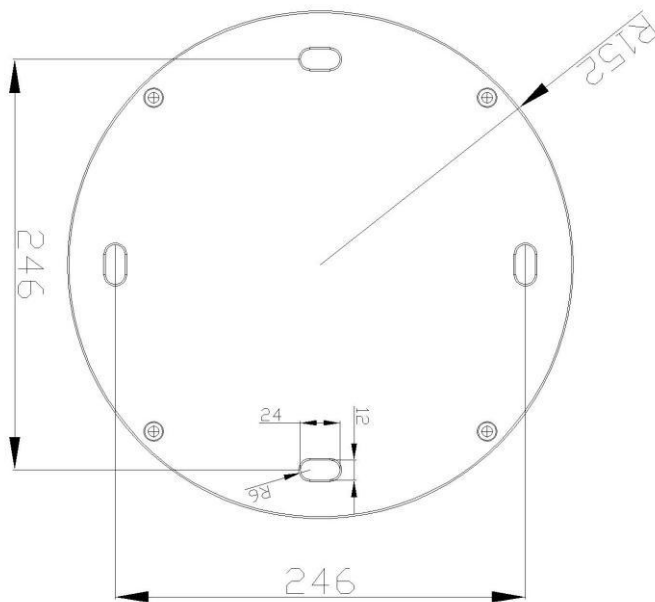
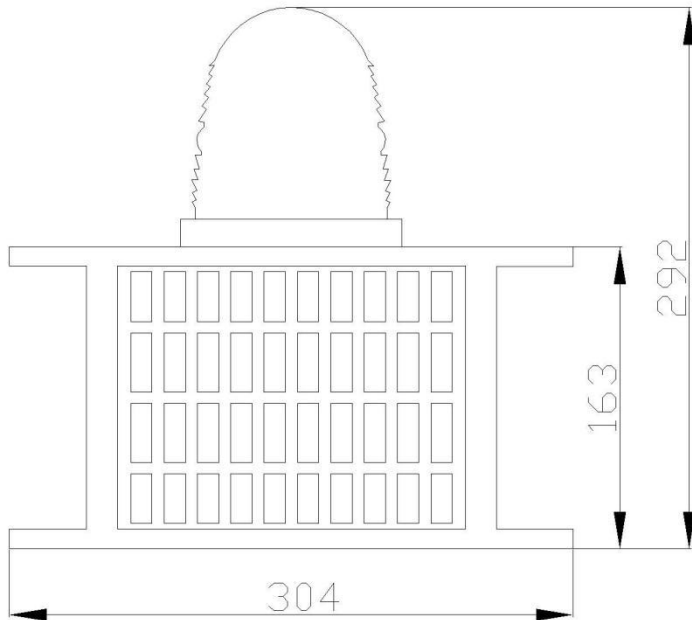

Unit:mm

Cases

